

Decoder Adapter for Märklin Locos, Item No. 8081mtc

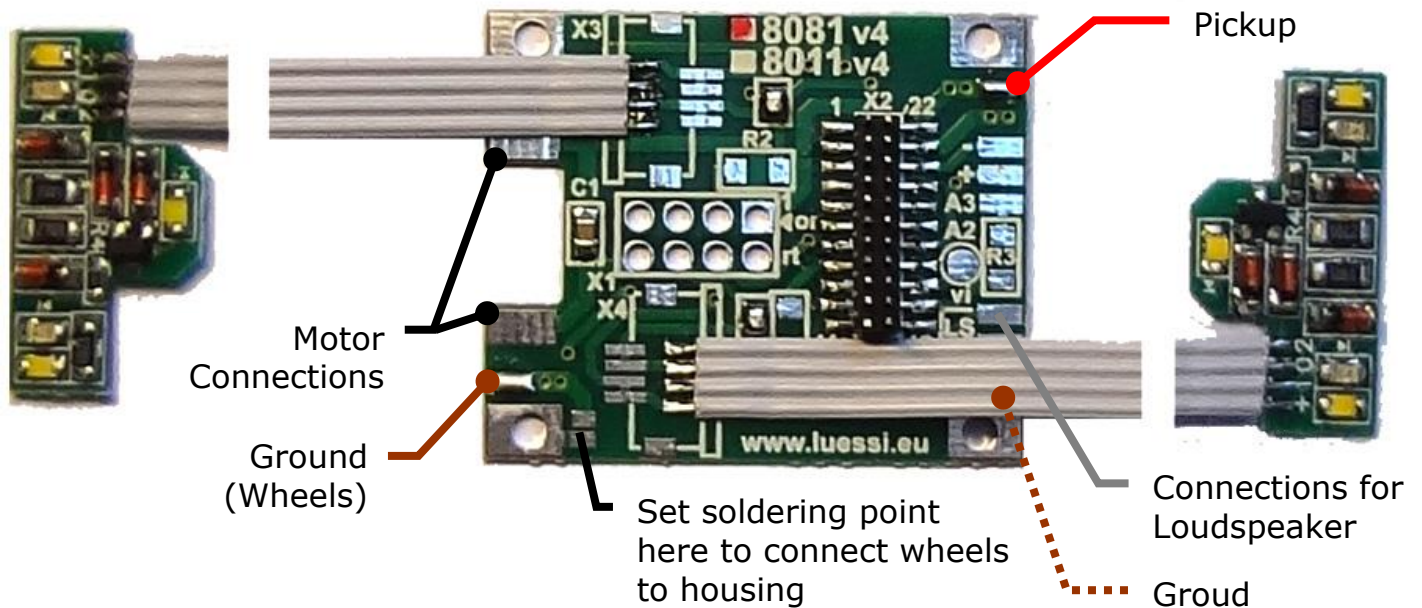

Hallsensor 1	1	22	■	Schiene rechts
Hallsensor 2	2	21	■	Schiene links
Hallsensor 3	3	20		DC (-) Funktionen GND
Aux 4	4	19	■	Motor rechts (+)
Zugbus Clock	5	18	■	Motor links (-)
Zugbus Data	6	17		Motor (3)
Licht hinten	■	7	16	■ DC (+) Funktionen
Licht vorne	■	8	15	■ Aux. 1 (F1)
Lautsprecher 2	■	9	14	■ Aux. 2 (F2)
Lautsprecher 1	■	10	13	Aux. 3 (F3)
Verdrehschutz	X	12		Vcc +5V Prozessor

The values of the series resistors on the carrier board are 0 Ω. The actual series resistors for the LEDs are located on the lighting boards.

Important note:

When putting on the locomotive case, there is a risk that the LEDs will be damaged by the light guides. Therefore, place the locomotive case carefully and without force!

1. Place the locomotive housing on one side at a slight angle. Make sure that the light guides do not damage the LEDs.
2. Push the locomotive box as far as it will go and hold it in this position.
3. Carefully lower the other side of the case.

